

1447 Peachtree Street NE,
Suite 850
Atlanta, Georgia 30309
phone: 404.873.6730

www.tsw-design.com
location

648 Union Street E.
Jacksonville, Florida

"Zoning Plan" Phase I: Surface Parking

Scale: 1" = 100'-0"



Copyright: All rights reserved.
Reproduction in whole or in part is prohibited. This drawing as an instrument of service is the property of the architect and may not be used in any way without the written permission of this office.

project title
Union Terminal Site

for
Columbia Ventures

drawing information
project number: n/a
contact: TSW
drawn by: TSW
checked by: TSW
scale: 1" = 100'

drawing date
03/08/2019

LEGEND:

- EXISTING BUILDING
- OFF-SITE RECREATION AND OPEN SPACE TO SUPPORT RESIDENTIAL USE

VICINITY MAP NOT TO SCALE

The vicinity map shows the site's location within a larger urban context. It includes Union Street West, Oakley Street, Palmello Street, and the Jacksonville Expressway. The site is located at the intersection of Union Street West and Oakley Street. Other streets shown include Beamer Street and Arlington Expressway.

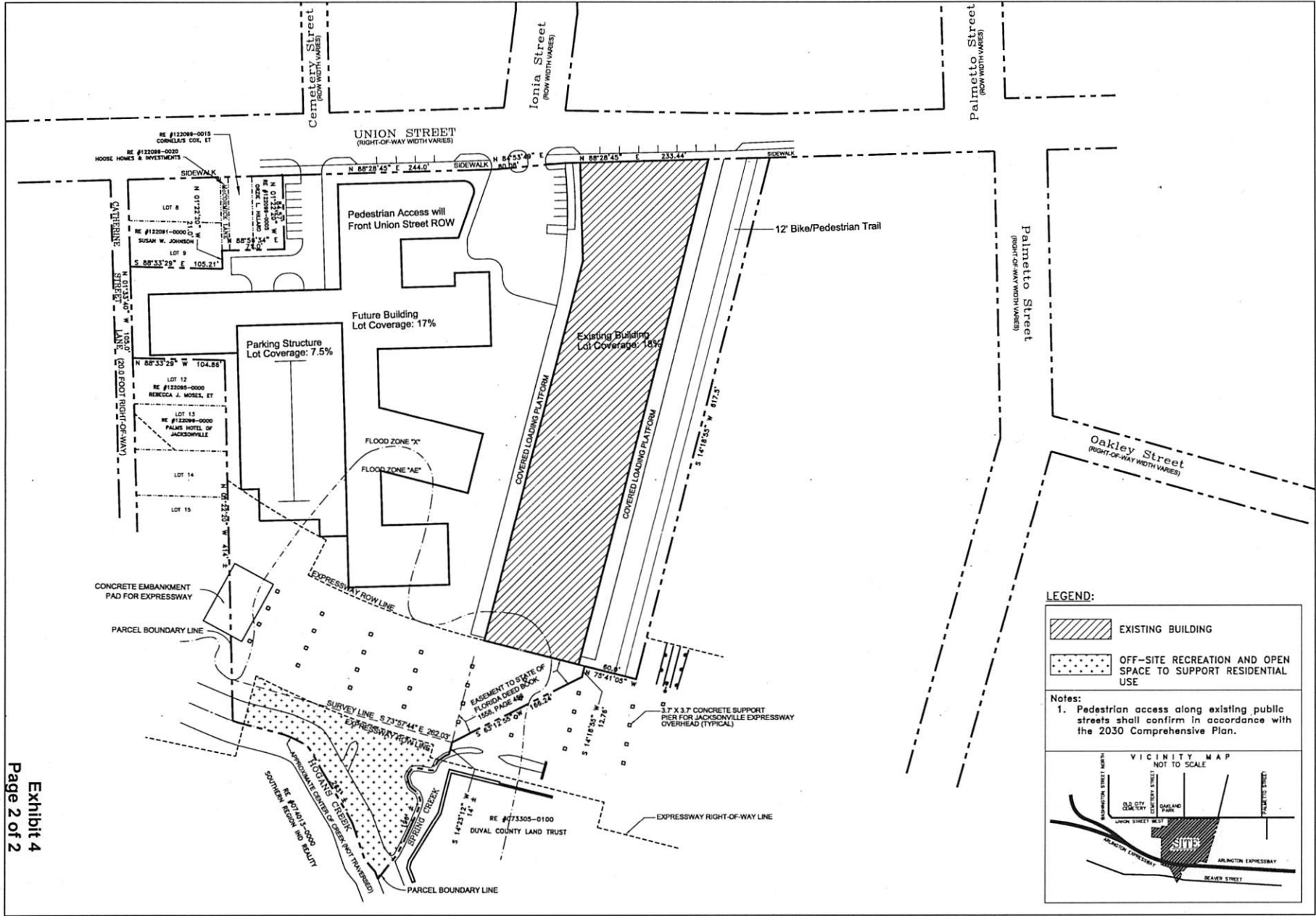

1447 Peachtree Street NE,
Suite 850
Atlanta, Georgia 30309
phone: 404.873.6730

www.tsw-design.com
location

648 Union Street E.
Jacksonville, Florida

"Zoning Plan" Phase II: Proposed Building

Scale: 1" = 100'-0"



Copyright. All rights reserved.
Reproduction in whole or in part is
prohibited. This drawing as an
instrument of service is the
property of the architect and may
not be used in any way without the
written permission of this
office

project title
Union Terminal Site
for
Columbia Ventures

drawing information
project number: n/a
contact: TSW
drawn by: TSW
checked by: TSW
scale: 1" = 100'
drawing date
03/08/2019

LEGEND:

- EXISTING BUILDING
- OFF-SITE RECREATION AND OPEN SPACE TO SUPPORT RESIDENTIAL USE

Notes:

- Pedestrian access along existing public streets shall confirm in accordance with the 2030 Comprehensive Plan.

VICINITY MAP NOT TO SCALE